

CERTIFIED LAND CORNER RECORDATION

DESCRIPTION OF CORNER EVIDENCE FOUND, AND ORIGINAL RECORD (If known)

LOCATION Found 1/2" dia. rebar, 1/2" below surface of graded road;
 S.12 S. 7 origin unknown. Accepted as corner monument.
 S.13 S.18 G.L.O. record - Unknown.
 R.64W. R.63W.
 T.13N.
 6th P.M.

DESCRIPTION OF MONUMENT AND ACCESSORIES ESTABLISHED
 TO PERPETUATE THE ORIGINAL LOCATION OF THIS CORNER:

At the corner: Drove found rebar approximately 2" below surface of road.
 Accessories: A 5/8" dia. x 24" long rebar with aluminum cap bears
 N 0°45'45" W, 35.62 feet distant. (R.P. No. 1)
 A 5/8" dia. x 24" long rebar with aluminum cap bears
 S 0°45'45" E, 36.20 feet distant. (R.P. No. 2)

SKETCH, WITH COURSE AND DISTANCE TO ADJACENT CORNER IF DETERMINED IN THIS SURVEY.
 (May Sketch or Paste Reproduction on Reverse Side.)

Basis of Bearing - By solar observation at this corner, P.E. = ±03".

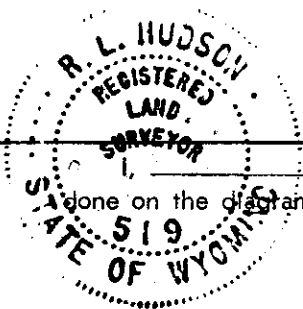
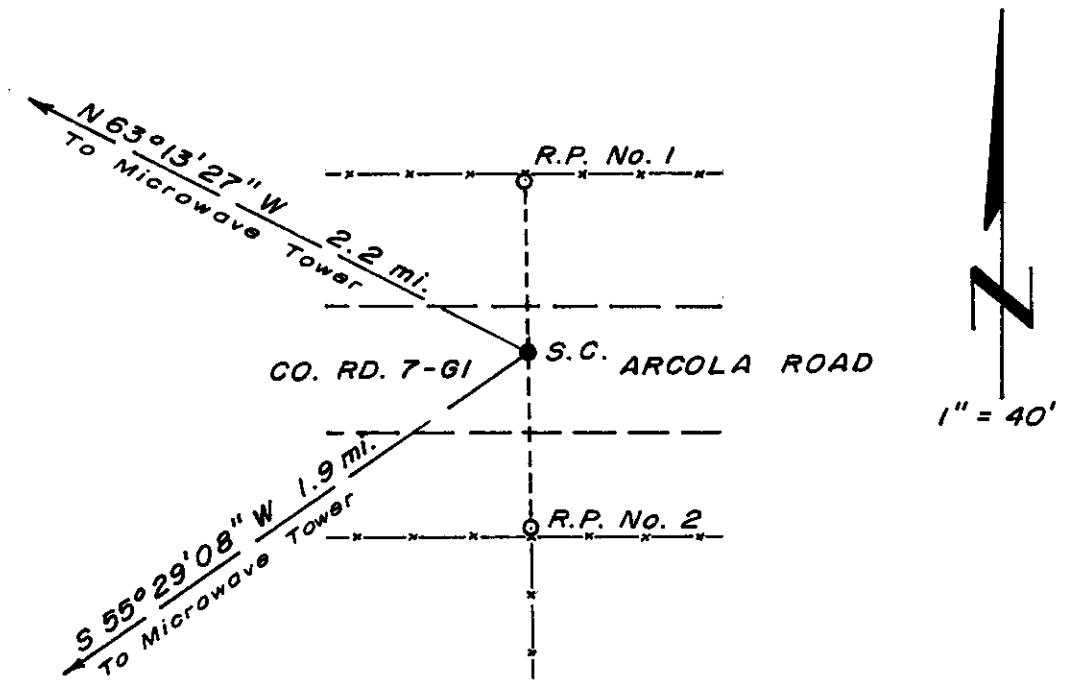

R. L. Hudson _____ certify that I have carefully performed ~~or reviewed~~ the work done on the diagrammed corner as reported on this recordation form and approve the same.

R. L. Hudson Wyoming L.S. No. 519
 Signature of Surveyor Registration No.

STATE OF WYOMING,
 Office of Clerk and Recorder,
 County of Taramie

716412

This "corner record" was filed for record on the 9 day of February, 1979, was noted on the cross-index plat and is assigned page No. _____, in book No. _____.

Janet C. Whitehead
 County Official

Cross Index No.	T. _____	R. _____	Mer.
	<u>J-25</u>	<u>13</u>	<u>64</u> Mer.
	T. _____	R. _____	Mer.
	<u>J-1</u>	<u>13</u>	<u>63</u> Mer.
	T. _____	R. _____	Mer.
	T. _____	R. _____	Mer.
	T. _____	R. _____	Mer.

J-25 13-64



16412

Photographed _____
Indexed _____
Posted _____
Assessor _____